

■ [ SPECIFICATION ]

Contact Resistance:  $\leq 100\text{m}\Omega$

Insulation Resistance:  $\geq 100\text{M}\Omega$

Withstand Voltage : 250V, AC/minute

Temperature Range :  $-20^{\circ}\text{C}\sim+70^{\circ}\text{C}$

Rated Load : 12V DC 50mA

Operation Force :

Life : 50000

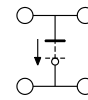
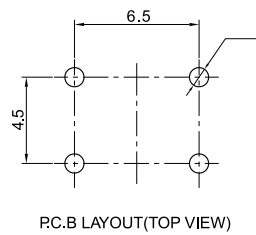
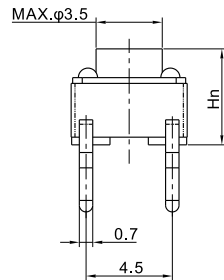
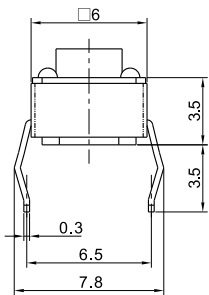

**KAN0611-0431B**

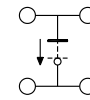
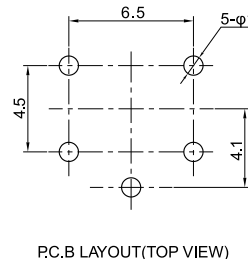
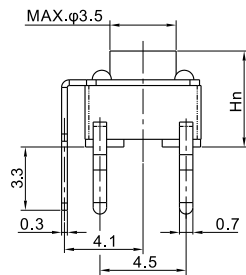
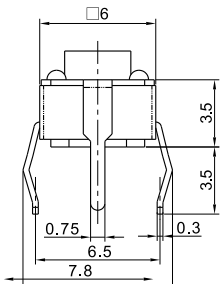

**KAN0621-0431B**

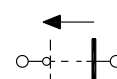
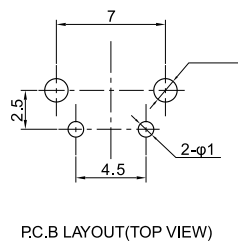
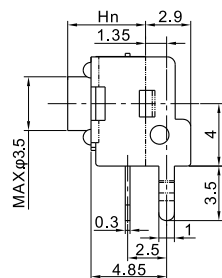
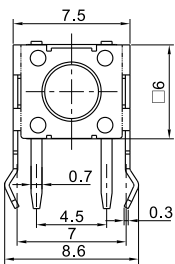

**KAN0631-0501B (SWT-7)**

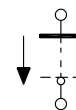
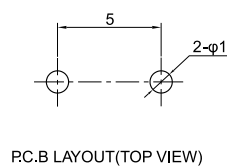
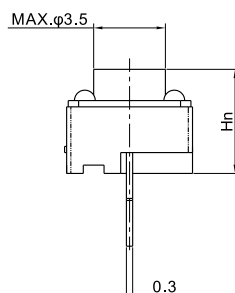
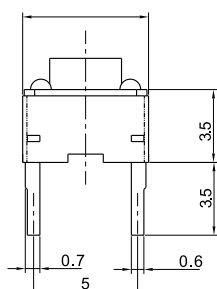

**KAN0653-0431B**